



48A Wallbox EV Charger Station With LCD Screen APP Wifi/Bluetooth 11.52 KW Type 1 EV Home Charger

Our Product Introduction

for more products please visit us on evstationcharger.com

Basic Information

- Place of Origin: China
- Brand Name: MINKO
- Certification: FCC, ETL, Energy Star
- Model Number: Wallbox-l48
- Minimum Order Quantity: 5 pieces
- Price: negotiation
- Packaging Details: L210xW85xH52 (mm)
- Delivery Time: 8 -10 working days
- Payment Terms: T/T, Western Union, MoneyGram, Paypal, Skrill, Transferwise
- Supply Ability: 1000000 pieces per month



Product Specification

- Charging Plug: Type 1
- Withstand Voltage: 3000v
- Input / Output Current: 8, 10, 12, 14, 16A , 20, 24, 28, 32A, 36A, 40A, 44A, 48A adjustable
- Max Output Power: 11.52 KW
- Cable Length: 7.4M
- Input Cable: 1M, Hard-wired
- Stand By: <3W
- IP Level: IP65
- Highlight: 48a easy wallbox ev charger, 11.52kw easy wallbox ev charger, 16a type 1 ev charger



More Images

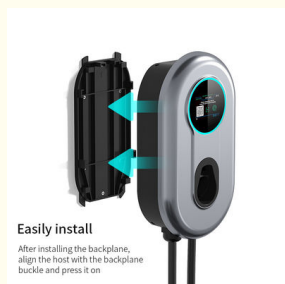

Product Description

48A Wallbox EV Charger Station With LCD Screen APP Wifi/Bluetooth 11.52 KW Type 1 EV Home Charger

Description of Type1 Wallbox EV Charger

This product is mainly composed of charging station host, charging gun, wire, installation backplane, installation ingredients package, etc. It is a household electric vehicle charging equipment. The AC charging station is connected to the mains, the electric vehicle will be safely and reliably charged by the charging gun interface; to avoid affecting the product performance, should no acid and alkali and other corrosive gases in the surrounding; try to avoid direct rain or use in environments with high humidity, and should try to prevent damage from impacting the housing.

Product parameter description:

Model	I40	I48
Input / Output Voltage	AC 110~240V / Single phase	AC 110~240V / Single phase
Input / Output Current	8, 10, 12, 14, 16A, 20, 24,28, 32A, 36A, 40Aadjustable	8, 10, 12, 14, 16A , 20, 24,28, 32A, 36A, 40A, 44A, 48Aadjustable
Max Output Power	9.6 KW	11.52 KW
Frequency	50/60Hz	
Input Cable	NEMA 14-50P / 1M, hard-wired	1M, hard-wired
Charging Plug	SAE J1772 (Type1)	
Length	7.4M	
Withstand Voltage	2000V	
Work Altitude	<2000M	
Stand by	<3W	
Operating temperature	-35°C to 50°C	
Start method	Card, WIFI, Bluetooth APP a variety of options to start charging	
Protection	over voltage protection, over load protection, over-temp protection, under voltage protection, earth leakage protection, lightning protection, short circuit protection	
IP level	IP65	
Touch Button	Yes	
LCD Screen	Yes	
Current Adjustment	Yes	
Bluetooth APP charging	Yes / No	
WiFi APP charging	Yes / No	
RFID	Yes	
Timing / Appointment	Yes / No	
Certification	FCC, ETL, Energy Star	
Warranty	1 Year for the whole machine	

Feature of Wallbox Charger Station with LCD Screen

1. The product complies with the Low Voltage Directive 2014/35/EU, IEC61851-1:2019
 2. IP65, weatherproof; leakage protection; impact resistance
 3. Charging status and working error are simply displayed by LED indicator light and LCD screen
 4. Optional unction of current selection button,
 5. 8A-48A free switching current
- Card, WIFI, Bluetooth a variety of options to start charging

Function introduction of Type1 Wallbox EV Charger

1.Residual current detection (RCD)

Ac leakage protection automatically detects the AC mismatch between the power supply wires, which indicates that the current flows through the grounded (PE) wire. Ac residual current fault protection will trip when the current is 30 Ma.

2.Surge protector

In: 3kA, I_{max}:6kA

3.Leakage protection

When the leakage protection is started, it needs to be cut off the power outage and restart.

4.Overcurrent protection

When the current exceeds the early warning value,the charging pile cuts off the power output, restarts automatically after 10 seconds, and does not recover automatically after 3 cycles until you cut of the power and restart.

5.Overvoltage protection

The protection starts when the voltage exceeds 275V, and automatically recovers when the voltage is restored and stabilized.

6.Undervoltage protection

Start the protection when the voltage is less than 100V, and restore automatically when the voltage is restored and stabilized.

7.Overttemperature protection

Start the protection when the internal temperature of the EV charging station exceeds 85 °C.

Installation Procedure:

1. Please use a percussion drill to drill holes according to the cardboard positioning

2. Install expansion bolts(6*M6*60MM)
3. fix the Mounting backplane with self-tapping screws(6*M5*50mm)
4. Align the main unit with the buckle on the back panel and install it, and then use screw to fix(4*M5*40)

Instructions

1. When the machine is on standby normally, the indicator light is fixed blue.
2. Remove the charging gun from the holder, insert the charging gun into the car charging socket.
3. After the gun insertion completed, the vehicle automatically starts to charge normally, and the blue meteor light on.
4. The indicator light always turns blue after the charge is completed.



COMPONENT FEATURES



EU Standard



US Standard

LED Charging Indicator
Beautiful Blue meteor light



LCD screen
Charging status display

Quick Mounting backplane
Simple and convenient installation method



EV Charging Plug
Self-cleaning pins
Temperature monitoring



TPU Cable
Long service life
Environment-friendly



wall End Wire

FUNCTION & PROTECTION



Over
Temperature
Protection



Type B
Leakage
Protection



Waterproof
& Dustproof
IP65



Ground
Protection



Over
Voltage
Protection



Over
Current
Protection



Short
Circuit
Protection



Lightning
Protection





Bluetooth connection can be made to control the charging process and set charging parameters through APP.

APP



Plug and play-swiping the card to start charging more convenient and faster.

RFID

PRODUCT SIZE



MINKO (SZ) TECHNOLOGY CO., LIMITED

+8613539872669

yumiko@szminko.com

evstationcharger.com

309 West Lake Industrial Zone, Cuishan Road, Dongxiao Street, Luohu District, SZ